



S(C) 30xx Installation Manual



D	INSTALLATIONS HANDBUCH	2
E	MANUAL DE INSTALACIÓN	22
F	MANUEL D'INSTALLATION	42
GB	INSTALLATION MANUAL	62
NL	INSTALLATIEHANDLEIDING	82
PL	INSTRUKCJA MONTAŻU	102

IMPORTANT NOTICE:

Install this device only when it complies with local/national legislation, ordinances and standards. This product is intended to be used as an air conditioner in residential houses and is only suitable for use in dry locations, in normal household conditions, indoors in living room, kitchen and garage. Check the mains voltage and frequency. This unit is only suitable for earthed sockets, connection voltage 230 V~ / 50 Hz.

This service manual is intended for use by individuals possessing adequate backgrounds of electrical, electronic, refrigerant and mechanical experience. Any attempt to install or repair the appliance may result in personal injury and property damage. The manufacturer or seller cannot be responsible for the interpretation of this information, nor can it assume any liability in connection with its use.

The information, specifications and parameter are subject to change due to technical modifications or improvement without any prior notice. The accurate specifications are presented on the nameplate label.

- Please read this installation manual completely before installing the product.
- When the power cord is damaged, replacement work shall be performed by authorized personnel only.
- Installation work must be performed in accordance with all European, national and / or local directives and standards and must be done by authorized personnel only. The guarantee is invalid for damage caused by neglect or by actions that deviate from those in this instruction booklet.
- Always make sure to wear the correct personal safety protections such as protective eyewear, gloves, mouthcaps, ear protection etc.

Internet:

For your convenience you can download the latest version of the user-, installation- and/or service manual on www.zibro.com

CONTENTS

SAFETY PRECAUTIONS	64
INSTALLATION OF INDOOR AND OUTDOOR UNITS	65
ELECTRICAL WORK	76
TEST RUNNING	80



WARNING!

Do not install, remove and/or reinstall the unit by yourself if you do not have the adequate electrical, electronic, refrigerant, mechanical experience and authorisation.

- Improper installation can cause water leakage, electrical shock, refrigerant leakage or fire. **Please consult authorized dealer or specialized air conditioner engineer for the installation work.** Please note faults caused by improper installation is not covered by warranty.
- Unit must be installed in an easily accessible area. Any additional cost required to hire special equipment to service the unit will be the responsibility of the customer

SAFETY PRECAUTIONS

The following should be always observed for safety:

- Be sure to read the following WARNING before installing the airconditioner.
- Be sure to observe the cautions specified here as they include important items related to safety.
- After reading this instructions, be sure to keep it together with the owners manual in a handy place for future reference.

The air conditioner contains a refrigerant and can be classified as pressurized equipment. Therefore always contact an authorized air conditioning engineer for installation and maintenance of the air conditioner. The air conditioner must be inspected and serviced on an annual base by an authorized air conditioning engineer.



WARNING

Do not install it yourself.

- Incorrect installation could cause injury due to fire, electric shock, the unit falling or leakage of water. Consult your dealer from whom you purchased the unit or an authorised installer.

Install the unit securely in a place which can bear the weight of the unit.

- When installed in an insufficiently strong place, the unit could fall causing injury.

Use the specified electrical wires to connect the indoor and outdoor units securely and attach the wires firmly to the terminal board connecting sections so the stress of the wires is not applied to the sections.

- Incorrect connection and fixing could cause a fire.

Be sure to use the provided or specified parts for the installation work.

- The use of defective parts could cause an injury due to a fire, electric shock, the unit falling, etc.

Perform the installation securely referring to the installation instruction.

- Incorrect installation could cause a personnel injury due to fire, electric shock, the unit falling or leakage of water.

Perform electrical work according to the installation manual and be sure to use an exclusive circuit.

- If the capacity of the power circuit is insufficient or there is incomplete electrical work, it could result in a fire or an electric shock.

Check that the refrigerant gas does not leak during installation or after installation is completed.

- Leaking refrigerant is bad for the environment and could cause global warming.

Attach the electrical part cover to the indoor unit and the service panel to the outdoor unit securely.

- If the electrical part covers off the indoor unit and/ or the service panel of the outdoor unit are not attached securely, it could result in a fire or electrical shock due to dust, water, etc.



CAUTIONS

This equipment must be earthed and installed with an earth leakage breaker. It can possibly cause electrical shock if grounding is not perfect.

Do not modify the length of the power supply cord. Do not use an extension cable. Otherwise it can cause electric fire or shock.

Do not install the unit in a place where a flammable gas leaks.

- If gas leaks and accumulates in the area surrounding the unit, it could cause an explosion.

Perform the drainage/piping work according to the installation instruction.

- If there is a defect in the drainage/piping work, water could leak from the unit and household goods could get wet and be damaged.

INSTALLATION OF INDOOR AND OUTDOOR UNITS

Read completely, then follow step by step.

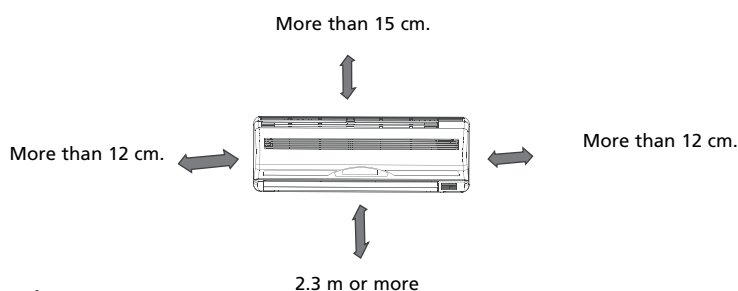

Fig. 1

Indoor unit

- Do not expose the indoor unit to heat or steam.
- Select a place where there are no obstacles in front or around the unit.
- Make sure that condensation drainage can be conveniently routed away continuously going downwards.
- Do not install near a doorway.
- Ensure that the space on the left and right of the unit is more than 12cm.
- Use a stud finder to locate studs to prevent unnecessary damage to the wall.
- The top of the indoor unit should be installed on the wall at a height of 2.3 metres or more from the floor.
- The indoor unit should be installed allowing a minimum clearance of 15cm from the ceiling.
- Any variations in pipe length will/may require adjustment to refrigerant charge.

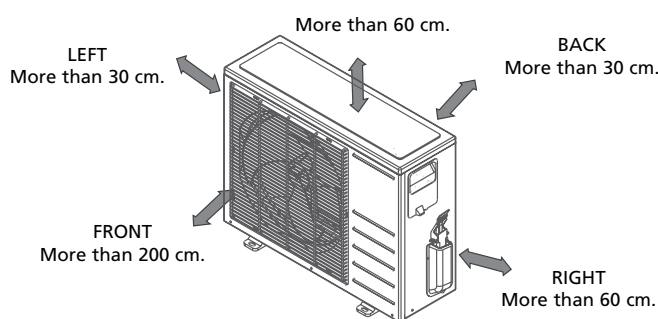

Fig. 2

Outdoor unit

- If an awning is built over the outdoor unit to prevent direct sunlight or rain exposure, make sure that heat radiation from the condenser is not restricted.
- Ensure that the clearance around the back of the unit is more than 30cm and left side is more than 30cm. The front of the unit should have more than 200cm of clearance and the connection side (right side) should have more than 60cm of clearance. (See picture 2)
- Do not place animals and plants or other obstacles in the path of the air inlet or outlet.
- Take the air conditioner weight into account and select a place where noise and vibration will not be an issue.
- Select a place so that the warm air and noise from the air conditioner do not disturb neighbours.
- Note that the outdoor unit produces sound when in use, this could interfere with local legislation. It is the responsibility of the user to check and to make sure the equipment is in full compliance with local legislation.
- Be sure to level the unit.

GENERAL

- Ensure the support structure and anchoring method are adequate for the unit location.
- Consult and follow local legislation regarding mounting and installation of air conditioner equipment.
- If the outdoor unit is installed on roof structures or external walls, this may result in excessive noise and vibration and may also be classed as a non serviceable installation.
- Always place the airconditioner in an easy accessible position.

ITEMS PACKED WITH THE UNIT (for SC 30xx models)

Number	Name of Accessories	Quantity
1	Installation plate	1
2	Clip Anchor	8
3	Self-tapping screw 'A' ST 3.9x25	8
4	Seal	1
5	Drain joint	1
6	Connecting pipe assembly	1
7	Remote controller	1
8	Self-tapping screw 'B' ST 2.9x10	2
9	Remote controller holder	1

ITEMS PACKED WITH THE UNIT (for S 30xx models)

Number	Name of Accessories		Quantity
1	Installation plate		1
2	Clip Anchor		8
3	Self-tapping screw 'A' ST 3.9x25		8
4	Seal		1
5	Drain joint		1
6	Connecting pipe assembly	Liquid side	Ø 6.35
			Ø 9.53 (< 3.5 kW model)
		Gas side	Ø 12.7 (≥ 3.5 kW model)
7	Remote controller		1
8	Self-tapping screw 'B' ST 2.9x10		2
9	Remote controller holder		1



NOTE!

Except the above provided parts, the other parts needed during installation are to be purchased separately by the buyer of the airconditioner.

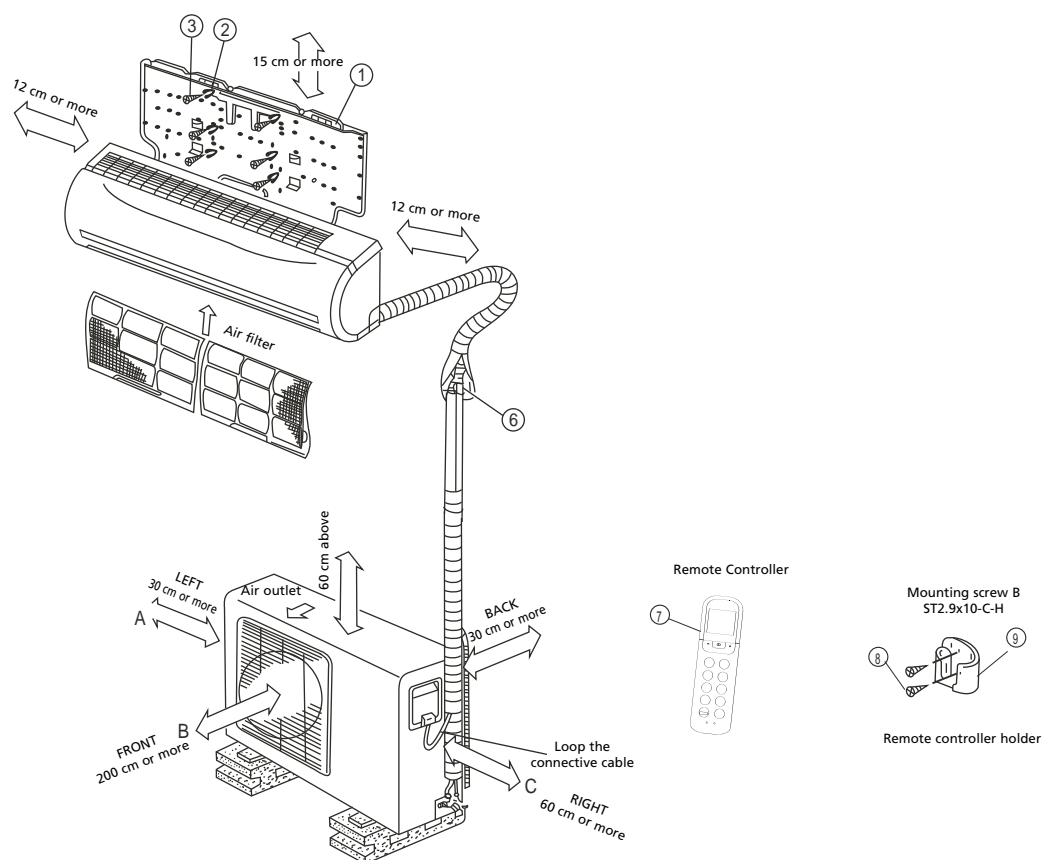

Fig. 3



CAUTION

- Ensure that the space around the left and right of the indoor unit is more than 12cm.
The indoor unit should be installed allowing a minimum clearance of 15cm from the ceiling.
- Use a stud finder to locate studs to prevent unnecessary damage to the wall.
- The indoor unit should be installed on the wall at a height of 2.3 metres or more from the floor.
- At least two of the directions A, B and C should be free from obstructions.



ATTENTION

This illustration is for explanation and indication purposes only. The illustration may be different from the airconditioner you purchased.



ATTENTION

Copper lines must be insulated independently from each other.

INDOOR UNIT INSTALLATION

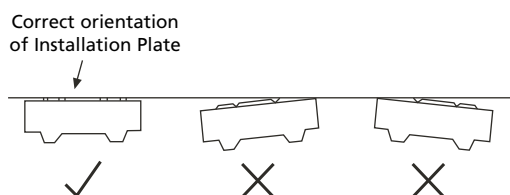

1. Fit the installation plate

1. Fit the installation plate ① horizontally on structural parts of the wall with spaces around the installation plate.
2. If the wall is made of brick, concrete or the like, drill eight (8) 5mm diameter holes in the wall. Insert Clip anchor ② for appropriate mounting screws ③.
3. Fit the installation plate ① on the wall with eight (8) type "A" screws ③.



NOTE

Fit the Installation Plate and drill holes in the wall according to the wall structure and corresponding mounting points on the installation plate. (Dimensions are in "mm" unless otherwise stated)

S 3025

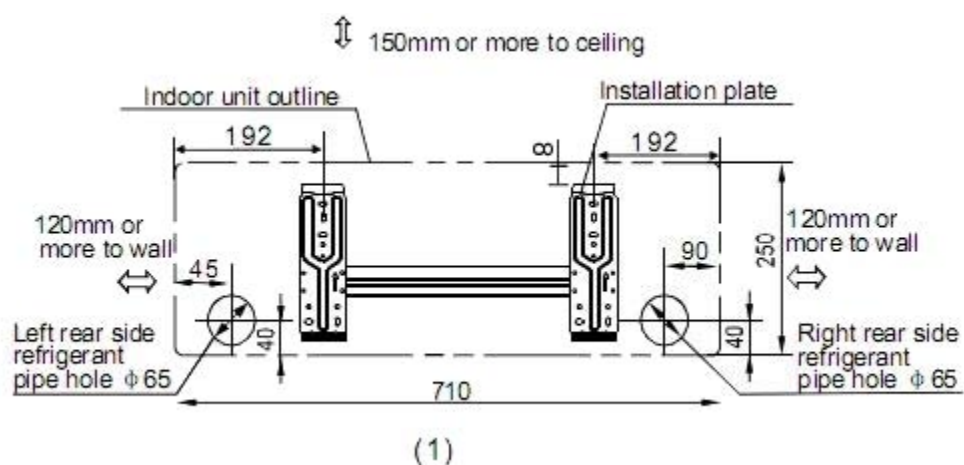

SC 3025

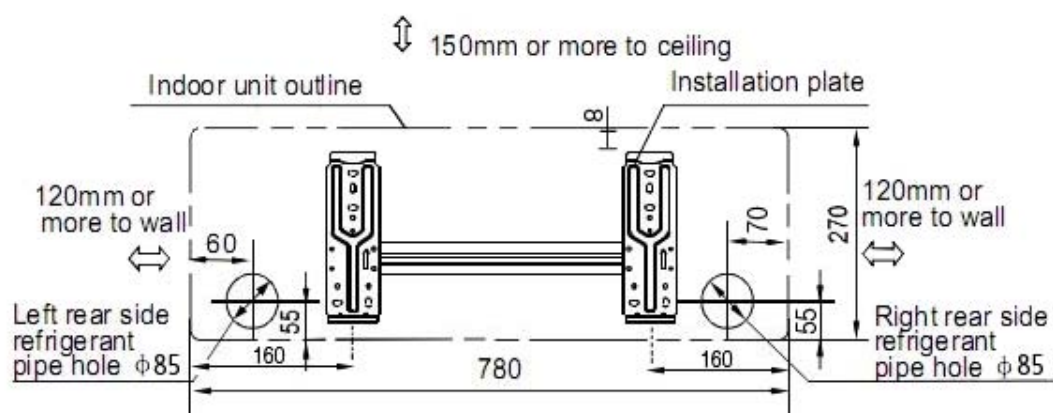

S 3032

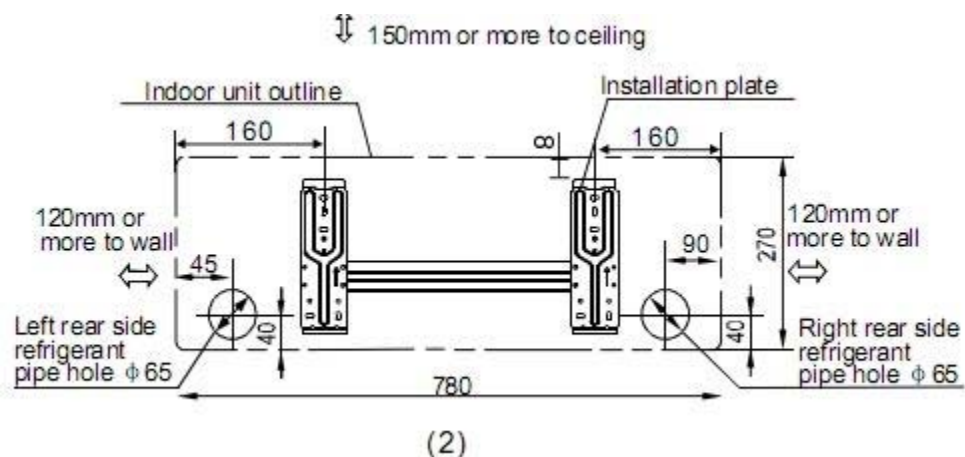

SC 3032

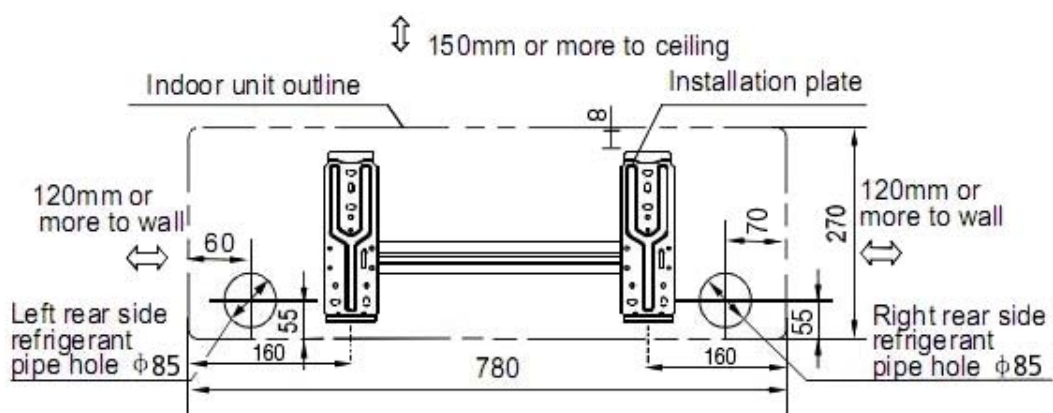

S 3050

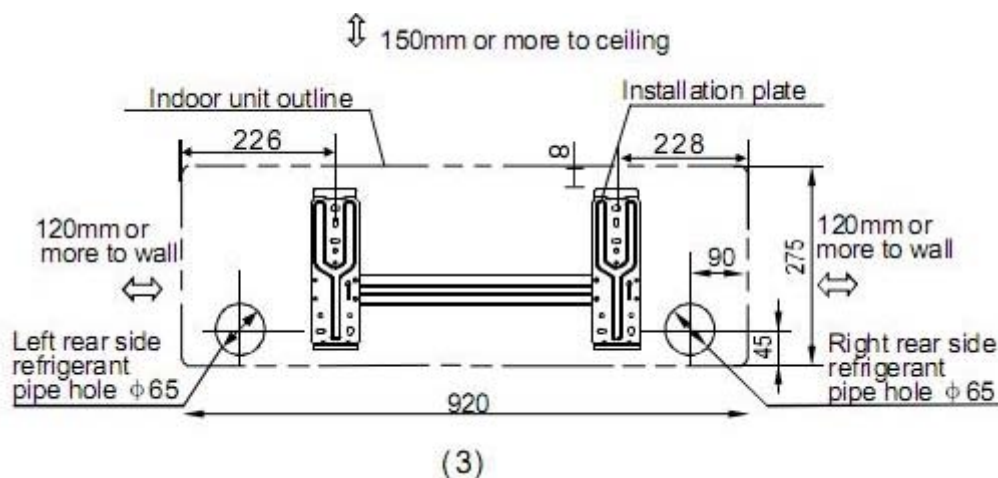

SC 3050

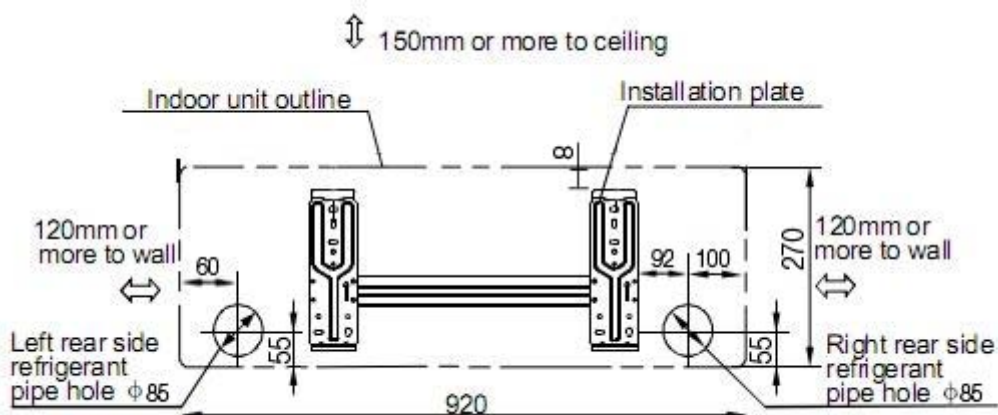

Fig. 4

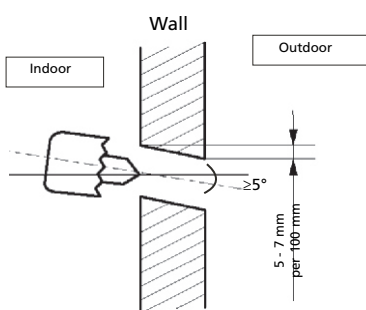

Fig. 5

2. Drill a hole in the wall

1. Determine hole positions according to the diagram detailed in Fig.5. drill one (1) hole (≥ 85 mm for SC30xx / ≥ 65 mm for S30xx) slanting slightly downwards to outdoor side, this will prevent water to come indoors.
2. Always use wall hole conduit when drilling metal grid, metal plate or the like.

3. Connective pipe and drainage installation



Always run the drain hose sloping downward all the way. Do **not** install the drain hose as illustrated below.

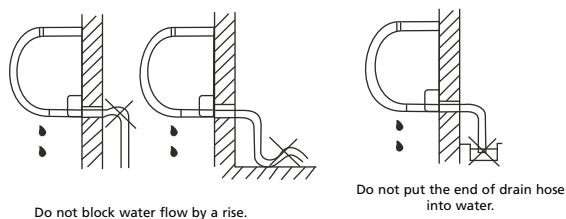

Fig. 6

1. When connecting extension drain hose, insulate the connecting part of extension drain hose with a shield pipe, do not let the drain hose slack.

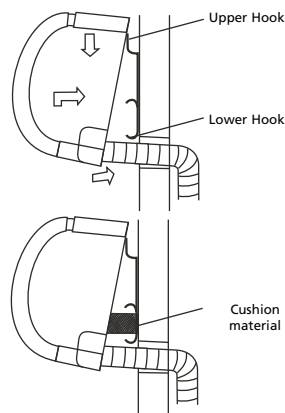

Fig. 7

Connective pipe

2. For the left-hand and right-hand piping, remove the pipe cover from the side panel. The pipe cover must be kept as it may be used when relocate the air conditioner to any other place.

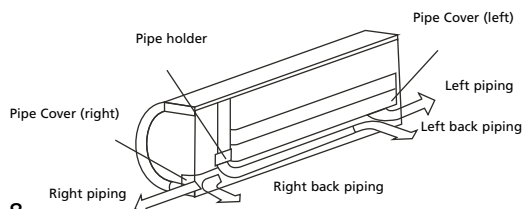

Fig. 8



ATTENTION

Always use the highest care when bending the piping. Make sure that the piping always is bended and not nodded. In case of a nodded pipe: do not attempt to install this nodded pipe as this is a potential refrigerant leak.

4. Indoor unit installation

For SC 30xx models

1. Pass the piping through the hole in the wall.
2. Put the upper claw at the back of the indoor unit on the upper hook of the installation plate, move the indoor unit from side to side to see that it is securely hooked.
3. The female half can be easily past through by lifting the indoor unit with a cushioning material between the indoor unit and the wall. Get it out after finishing it.
4. Push the lower part of the indoor unit up on the wall. Then move the indoor unit from side to side, up and down to check if it is hooked securely.

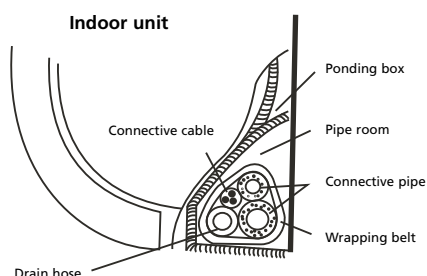

Fig. 9

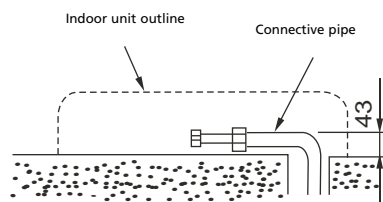

Fig. 10

For S 30xx models

For the rear-right-hand and rear-left-hand piping, install the piping as shown. Bend the connective pipe to be laid at 43mm height or less from the wall. (fig. 9 and 10)

1. Pass the piping through the hole in the wall.
2. Put the upper claw at the back of the indoor unit on the upper hook of the installation plate, move the indoor unit from side to side to see that it is securely hooked.
3. Piping can easily be made by lifting the indoor unit with a cushioning material between the indoor unit and the wall. Get it out after finish piping.
4. Push the lower part of the indoor unit up on the wall. Then move the indoor unit from side to side, up and down to check if it is hooked securely.



See picture 11:

Bending the refrigerant piping at the back of the unit needs to be done with the highest care! The piping consists out of copper. When bending the highlighted part more than 1 time the Copper will start cracking due to a physical process. Cracking can cause leakage refrigerant leakage and is not covered by the warranty.

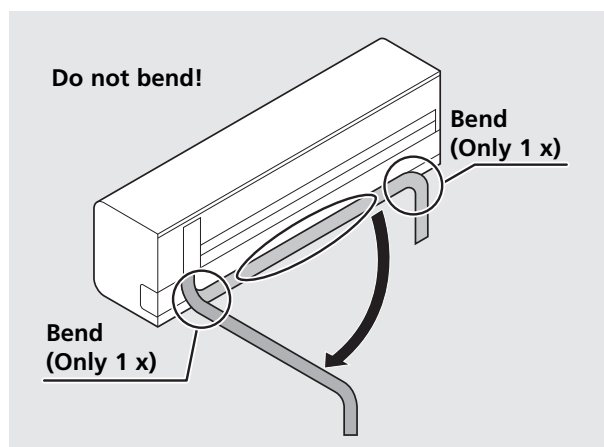

Fig. 11

5. Piping and wrapping

Bundle the tubing, connecting cable, and drain hose with tape securely, evenly as shown in Fig.9.



ATTENTION

- Because the condensed water from rear of the indoor unit is gathered in ponding box and is piped out of room. Do not put anything else in the box.
- Connect the indoor unit first, then the outdoor unit. (S 30xx)



CAUTION

- Do not allow the piping to let out from the back of the indoor unit.
- Be careful not to let the drain hose slack.
- Heat insulate both of the auxiliary piping.
- Be sure that the drain hose is located at the lowest side of the bundle. Locating at the upper side can cause drain pan to overflow inside the unit.
- Never intercross nor intertwist the power wire with any other wiring.
- Run the drain hose sloped downward over the whole length to drain out the condensed water smoothly.

OUTDOOR UNIT INSTALLATION

Outdoor installation precaution

- Install the outdoor unit on a rigid base to prevent increasing noise level and vibration.
- Determine the air outlet direction where the discharged air is not blocked.
- In the case that the installation place is exposed to strong wind such as a seaside, make sure the fan operating properly by putting the unit lengthwise along the wall or using a dust or shield plates.
- Specially in windy area, install the unit in such way that the admission of wind is prevented.
- Be sure there are no obstacles blocking the airflow.



ATTENTION

If need suspending installation, the installation bracket should accord with all technical requirements. The installation wall should be strong enough or actions to reinforce should be taken. The connection between bracket and wall, bracket and the air conditioner should be firm, stable and reliable. In case of any doubts or uncertainty do not attempt to install the unit but have the support calculated and engineered by a skilled engineer.

For capacities $\leq 7,0$ kW: never place the outdoor unit over 5 meters higher or over 5 meters lower than the indoor unit.

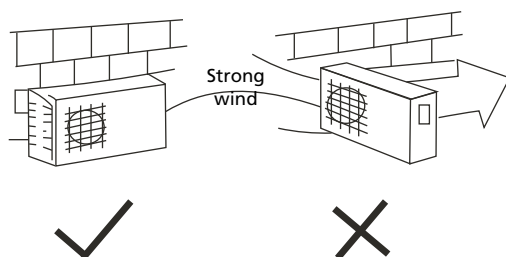

Fig. 12

Settlement of outdoor unit

Anchor the outdoor unit with bolts, lock washers and nuts $\varnothing 10$ mm or $\varnothing 8$ mm tightly and horizontally on a concrete or rigid mount.

Outdoor unit dimensions in mm (WxHxD)	Mounting dimensions	
	A (mm)	B (mm)
700x535x235	458	250
685x430x260	460	276
780x540x250	549	276
760x590x285	530	290
845x695x335	560	335
660x540x250	481	276

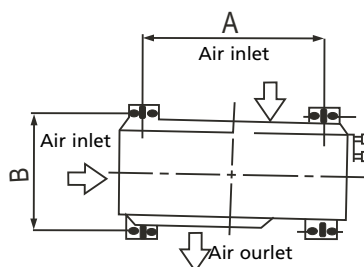

Fig. 13

Drain joint installation

(see fig. 14)

Fit the seal into the drain elbow, then insert the drain joint into the base pan hole in the bottom of the outdoor unit, rotate 90° to assemble them securely. Connect the drain joint with an extension drain hose (not included). In this way condensed water, which is produced during heating mode of the airconditioner, can be drained away.

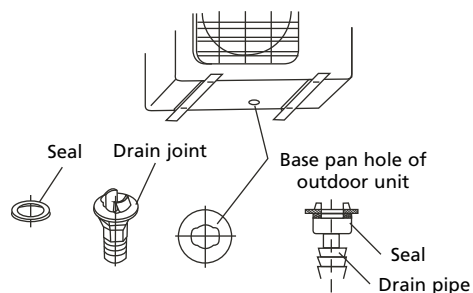

Fig. 14

For SC30xx models

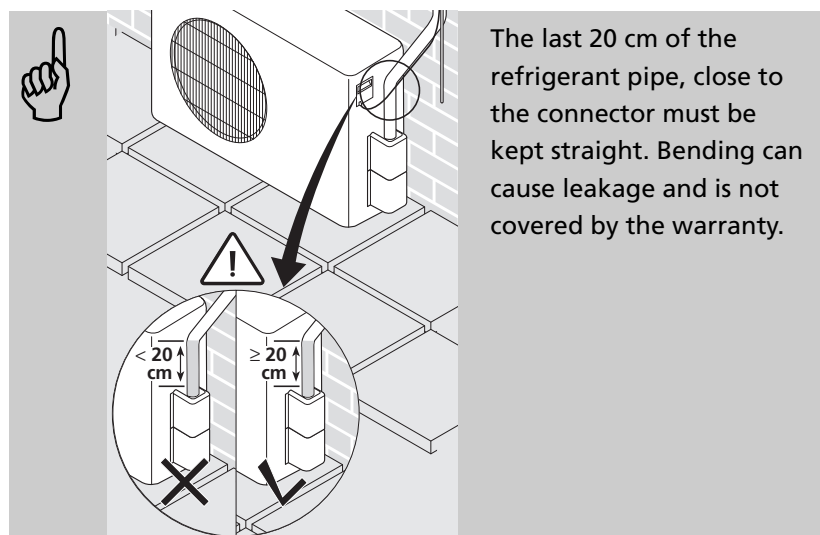

Fig. 15

REFRIGERANT PIPING CONNECTION



ATTENTION

All refrigerant work and refrigerant piping should comply with the local legislation, standards and codes and should only be done by qualified and skilled people.



CAUTION

For your safety, always wear safety eye wear and work gloves when connecting the pipes.

For SC 30xx models

See 'Quick Installation Guide'.

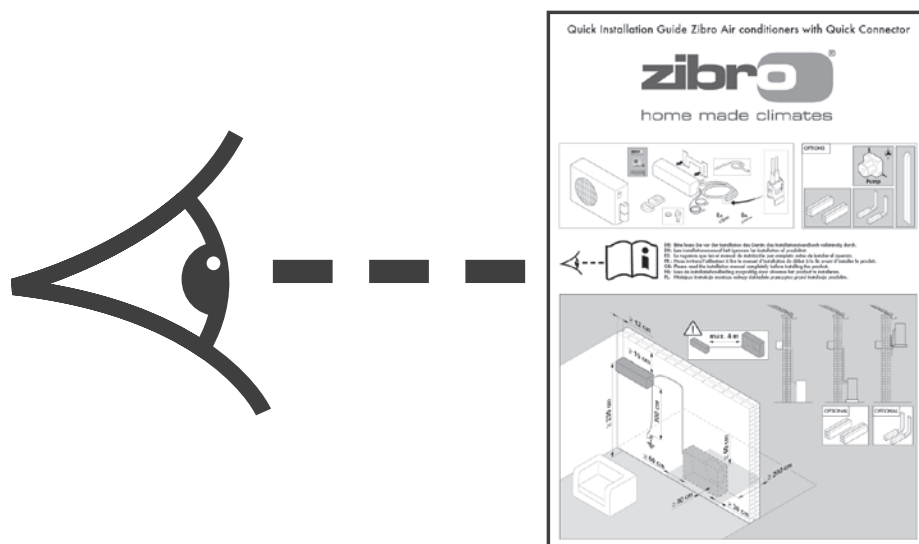

Fig. 16

To disconnect the couplings:

- Step 1: Shut down the A/C unit and unplug the electrical power cord from the wall outlet.
- Step 2: Wait five minutes for the line pressure between the indoor compressor unit and outdoor condensing unit to equalize.
- Step 3: Pull the male coupling handle up and toward the male coupling to the full back position.
- Step 4: Retract the Release Sleeve on the female coupling to release the male coupling half from the female half.
- Step 5: To seal and protect from dust, reinstall the protective cap and plug.



ATTENTION

All refrigerant work and refrigerant piping should comply with the local legislation, standards and codes and should only be done by qualified and skilled people.

REFRIGERANT PIPING CONNECTION (for S 30xx models)

- Align the centre of the pipes.
- Sufficiently tighten the flare nut with fingers, and then tighten it with a spanner and torque wrench as shown (see fig. 19 and fig. 20).
- Select the correct tightening torque (shown table 1) in order to prevent the pipes, connecting pieces and nuts from being damaged.

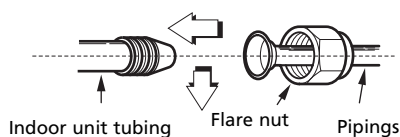

Fig. 19

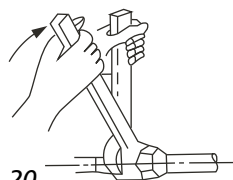

Fig. 20



ATTENTION

- Excessive torque can break nut depending on installation conditions.
- All refrigerant work and refrigerant piping should comply with the local legislation, standards and codes and should only be done by qualified and skilled engineers.

Outer diam.	Tightening torque (N.cm)	Additional tightening torque (N.cm)
Ø 6.35	1570 (160kgf.cm)	1960 (200kgf.cm)
Ø 9.53	2940 (300kgf.cm)	3430 (350kgf.cm)
Ø 12.7	4900 (500kgf.cm).	5390 (550kgf.cm)

Table 1: tightening torque

ELECTRICAL WORK

Electric safety regulations for the initial Installation

1. In case of an unsafe (electrical, mechanical and/or refrigerant etc) situation do not install the airconditioner.
2. Power voltage supplied should be in the range of 95%~105% of rated voltage on rating table.
3. A creepage protector and a main power switch with a 1.5 times capacity of max. current of the unit should be installed in power circuit.
4. Ensure the air conditioner is grounded well.
5. Connect the wires according the attached electrical connection diagram located on the panel of the outdoor unit.
6. All wiring must comply with local and national electrical standards and codes and be installed by qualified and skilled people.
7. An individual branch circuit and single receptacle used only for this air conditioner must be available. See the following table for suggested fuse specifications:

Model	Power supply	Input Rated Current (Switch/Fuse)	Power cord size
≥ 2,4 kW	230V~50Hz	16A	2,5 mm ²



NOTE!

The supply voltage should be consistent with the rated voltage of the air conditioner.

Connect the cable to the indoor unit (for SC 30xx models)

1. 4.5 Meter cable for electrical connection between indoor and outdoor unit is delivered with the package and is included in the refrigerant piping sleeve.
2. The electrical cable is provided with an electrical quick connector.
3. The outdoor unit is also provided with electrical quick connector.
4. Connect the electrical quick connectors.

Connect the green/yellow earthing wire separately to the connection spot marked with .

Connect the cable to the indoor unit (for S 30xx models)

1. Indoor/Outdoor connection cable should be H07RN-F type.
2. Remove the panel and screw, then remove the window cover. (fig. 21)
3. Connect cables according to their marks to terminals. (fig. 22)
4. Wrap those cables not connected with terminals with insulation tapes, so that they will not touch any electrical components.
5. Fit the power cord clamp.

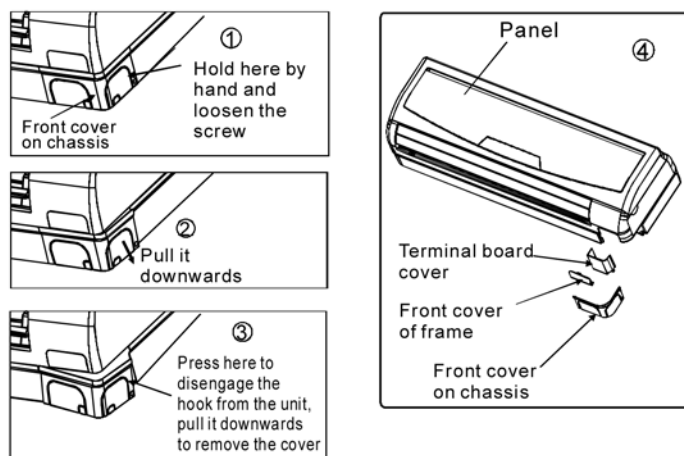

Fig. 21

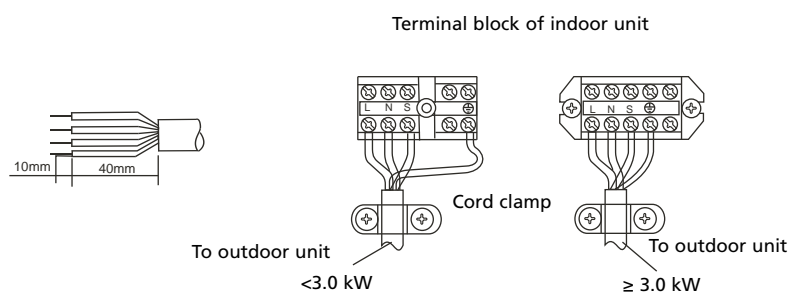

Fig. 22

Connect the cable to the outdoor unit (for SC 30xx models)

1. The connection cables of indoor and outdoor units have been connected to the terminals on the control board except the grounding wire (Y/G), only white plug connectors exposed.
2. Remove the control cover from the outdoor unit by loosening the screw.
3. Hold the indoor plug connector and insert the mating plug connector located on the outdoor unit until it fixed with a clicking sound. Secure the cable onto the control board with the cord clamp.
4. Connect the grounding wire to the terminal on the control board individually.
5. The electrical connection is finished now.

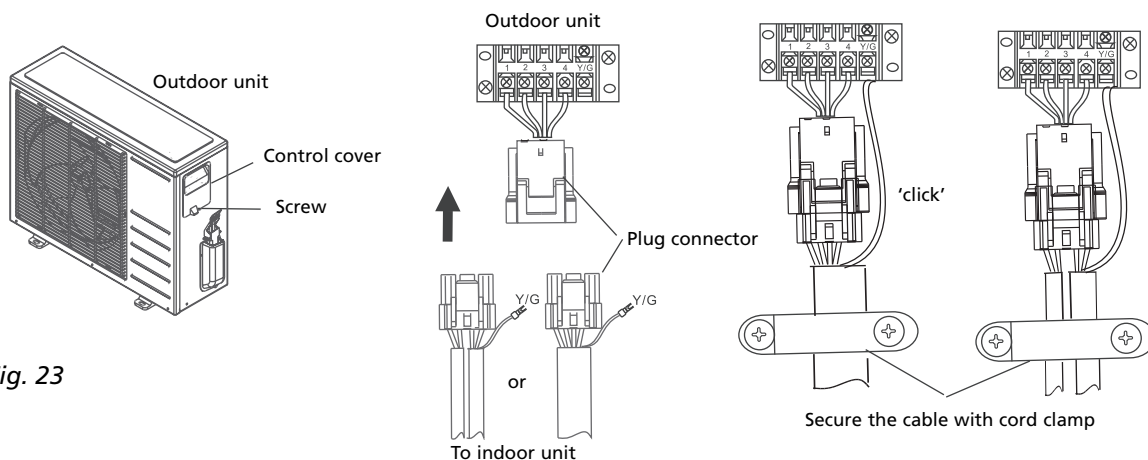

Fig. 23

CAUTION



After the confirmation of the above conditions, prepare the wiring as follows:

- Always have an individual power circuit specifically for the air conditioner. As for the method of wiring, be guided by the circuit diagram posted on the inside of control cover.
- The screw which fasten the wiring in the casing of electrical fittings are liable to come loose from vibrations to which the unit is subjected during the course of transportation. Check them and make sure that they are all tightly fastened. (If they are loose, it could cause burn-out of the wires.)
- Check specification of power source.
- Confirm that supplied electrical capacity is sufficient.
- See to that the starting voltage is maintained at more than 90 percent of the rated voltage marked on the name plate.
- Confirm that the cable thickness is as specified in the power source specification.
- Always install an earth leakage circuit breaker.
- The following would be caused by voltage drop: Vibration of a magnetic switch, which will damage the contact point, fuse breaking, disturbance of the normal function of the overload.
- The means for disconnection from a power supply shall be incorporated in the fixed wiring and have an air gap contact separation of at least 3mm in each active(phase) conductors.

Connect the cable to the outdoor unit (for S 30xx models)

(see fig. 24)

1. Remove the electric parts cover from the outdoor unit.
2. Connect the connective cables to the terminals as identified with their respective matched numbers on the terminal block of indoor and outdoor units.
3. To prevent the ingress of water, form a loop of the connective cable as illustrated in the installation diagram of indoor and outdoor units.
4. Insulate unused cords (conductors) with PVC-tape. Make sure they do not touch any electrical or metal parts.

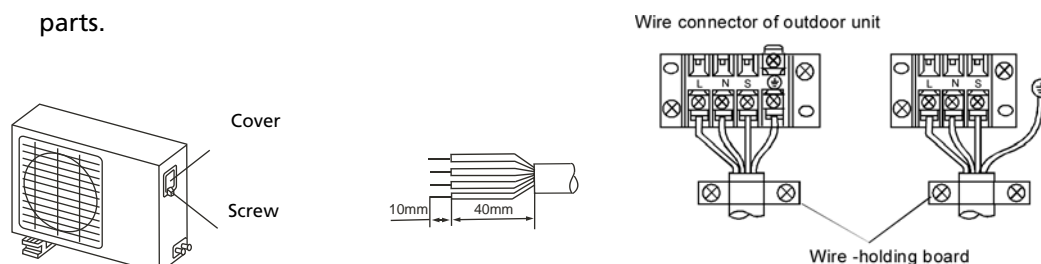

Fig. 24

AIR PURGING (for S 30xx models)

Air and moisture that remain in the refrigerant system, e.g. after installation, can cause undesirable effects or damage as indicated below:

- Pressure in the system rises.
- Operating current rises.
- Cooling or heating efficiency drops.
- Moisture in the refrigerant circuit may freeze and block capillary tubing.
- Water may lead to corrosion of parts in the refrigeration system.
- Damage of the compressor.

Therefore, the indoor unit and tubing between the indoor and outdoor unit must always be leak tested and evacuated with aid of a vacuum pump to remove any noncondensables and moisture from the system.

PIPE LENGTH AND REFRIGERANT AMOUNT (for S 30xx models)

Connective pipe length	Air purging method	Additional amount above rating label amount of refrigerant to be charged
Less than 5m	Use vacuum pump.	-----
5~10m	Use vacuum pump.	Liquid side pipe diameter: ø 6.35 (Pipe length-5)x30g

- When relocate the unit to another place, perform evacuation using vacuum pump.
- Make sure the refrigerant added into the air conditioner is in liquid form in any case.
- Only use the type of refrigerant as stated on the rating label.

ELECTRICAL SAFETY CHECK AND GAS LEAK CHECK

It is advised to do the following safety checks.

Electrical safety check

Perform the electric safe check after completing installation:

1. Insulated resistance
The insulated resistance must be more than 2M .
2. Grounding work
After finishing grounding work, measure the grounding resistance by visual detection and grounding resistance tester. Make sure the grounding resistance is less than 4 .
3. Electrical leakage check (performing during test running)
During test operation after finishing installation, use an electroprobe and multimeter to perform the electrical leakage check. Turn off the unit immediately if leakage happens. Check and find out the solution ways till the unit operate properly.

Gas leak check

1. Soap water method:
Apply a soap water or a liquid neutral detergent on the indoor unit connection or outdoor unit connections by a soft brush to check for leakage of the connecting points of the piping. If bubbles come out, the pipes have leakage.
2. Dedicated special leak detector
Use the leak detector to check for leakage.

TEST RUNNING

Perform test running after completing electrical safety check and gas leak check.

The test running time should last more than 30 minutes.

1. Open the panel and lift the panel up to an angle which remains fixed. Do not lift the panel any further when it stops with a click sound.
2. Press the manual control button twice until the operating indicator lights up, the unit will operate on Forced Cool mode.
3. Check if all the functions works well during test running. Especially check whether the drainage of indoor unit is smooth or not.
4. Press the manual switch button again after finishing the test running . The operating indicator turns dark and the unit stops operating and is now ready for use.

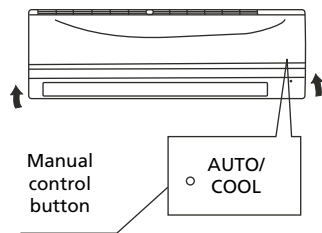

Fig. 25



- Ⓓ Benötigen Sie weitere Informationen oder treten Probleme auf, besuchen Sie bitte unsere Website www.zibro.com, oder setzen Sie sich mit unserem Kundendienst in Verbindung (Telefonnummer auf www.zibro.com).
- Ⓔ For alle yderligere oplysninger eller ved eventuelle problemer med apparatet henvises til www.zibro.com eller det lokale Kundecenter (telefonnumre findes i www.zibro.com).
- Ⓔ Si necesita información o si tiene algún problema, visite nuestra página Web www.zibro.com, o póngase en contacto con el servicio cliente (hallará el número de teléfono en www.zibro.com).
- Ⓕ Si vous souhaitez obtenir des informations supplémentaires ou si vous rencontrez un problème, rendez-vous sur notre site Web (www.zibro.com) ou contactez le notre service client (vous trouverez l'adresse et numéro de téléphone sur www.zibro.com).
- Ⓖ Jos haluat huoltoapua, lisätietoja tai laitteen kanssa tulee ongelmia, tutustu verkkosivustoon osoitteessa www.zibro.com tai kysy neuvoa PVG kuluttajapalvelukeskuksesta (www.zibro.com).
- ⒼB If you need information or if you have a problem, please visit the our website (www.zibro.com) or contact our sales support (you find its phone number on www.zibro.com).
- Ⓘ Per informazioni e in caso di problemi, visitate il sito Web www.zibro.com oppure contattate il Centro Assistenza Clienti (per conoscere il numero di telefono, consultate www.zibro.com).
- Ⓝ Hvis du trenger informasjon, eller hvis du har et problem med produktet, kan du gå til nettsidene www.zibro.com. Alternativt kan du kontakte med PVG' forbrukertjeneste (telefonnummeret i www.zibro.com).
- ⓃL Als u informatie nodig hebt of als u een probleem hebt, bezoek dan de onze website (www.zibro.com) of neem contact op met de afdeling sales support (adres en telefoon op www.zibro.com).
- Ⓕ Se necessitar de informações ou se tiver problemas, visite o Web site www.zibro.com ou contacte o Centro de Assistência (número de telefone o www.zibro.com).
- Ⓟ W przypadku problemów i w celu uzyskania szczegółowych informacji odwiedź stronę internetową Zibro dostępną pod adresem www.zibro.com lub skontaktuj się z Centrum kontaktów Zibro (www.zibro.com).
- Ⓢ Om du behöver service eller information eller har problem med apparaten kan du besöka www.zibro.com eller kontakta Zibro kundtjänst (du hittar telefonnumret på www.zibro.com).
- Ⓔ Če želite dodatne informacije, obiščite spletno mesto podjetja na naslovu www.zibro.com ali pokličite na telefonsko (www.zibro.com).
- Ⓓ Daha fazla bilgiye ihtiyaç duyarsanız veya bir sorunla karşılaşırsanız, www.zibro.com adresindeki Zibro Internet sitesini ziyaret edin veya ülkenizde bulunan Zibro müşteri merkeziyle iletişim kurun (telefon numarasını: www.zibro.com).